

Pablo®

PICCOLA

ASSEMBLY & INSTALLATION INSTRUCTIONS



APPROVED COMPONENTS

Pablo® PICCOLA

ASSEMBLY

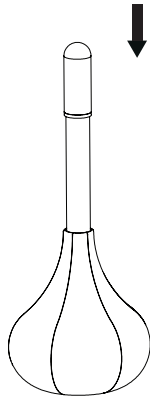
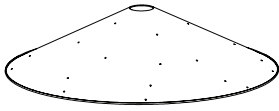

1

PLACE SHADE ON TOP OF GLASS TUBE

BULB TYPE

120V/35W (35W MAXIMUM)
GY6JCD BI-PIN HALOGEN



CARE INSTRUCTIONS

WIPE CLEAN WITH A SOFT DAMP CLOTH.
AVOID AMMONIA-BASED CLEANERS.

ADJUSTMENT

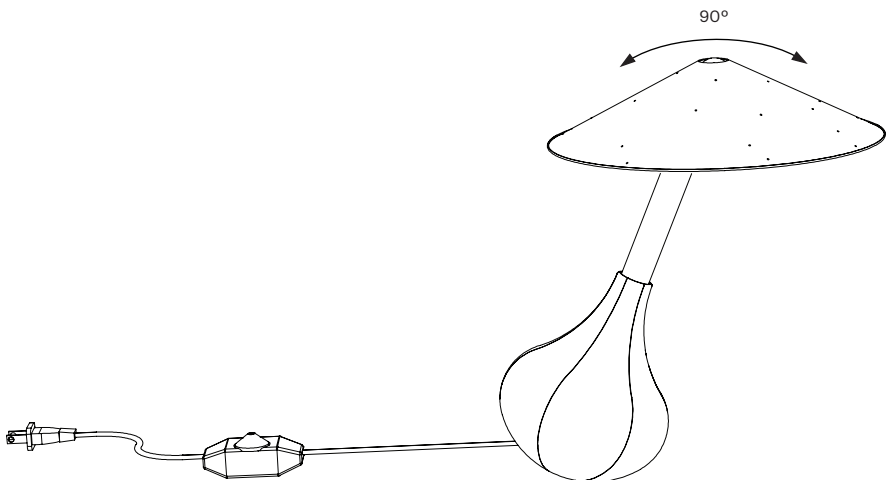

Pablo® PICCOLA

BULB REPLACEMENT

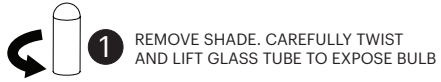
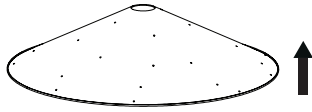

REMOVE SHADE. CAREFULLY TWIST
AND LIFT GLASS TUBE TO EXPOSE BULB

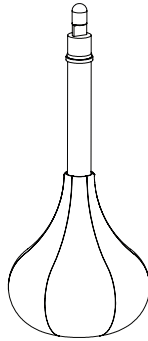

NOTE: CONTACT MANUFACTURER FOR
REPLACEMENT GLASS TUBES



CAREFULLY LIFT BULB FROM STEM

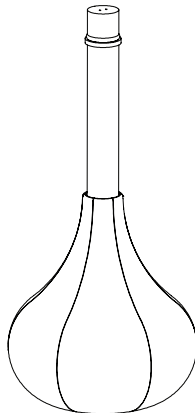

Pablo®

PICCOLA

INFO@PABLODESIGNS.COM
888 MARIN STREET
SAN FRANCISCO, CA
94124

PABLODESIGNS.COM